

# ROOF-to-SIDEWALL Detail

## Metro Sidewall UNDERPAN Metal & Z-BAR

**(EXPOSED Fastened Panels - MetroSHAKE®, MetroTILE®, MetroROMAN® & MetroCOTTAGE™ Shingle)**

Panels **DIRECT to DECK**

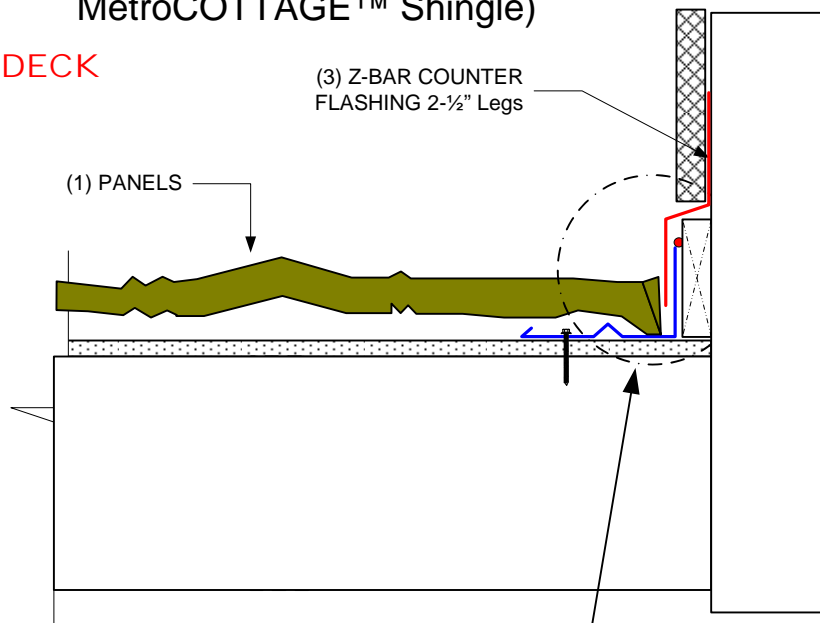

(3) Z-BAR COUNTER FLASHING 2-1/2" Legs

(1) PANELS

(5) SEALANT Bead along top of Side-Wall Underpan metal as shown

(4) SIDE-WALL UNDER-PAN

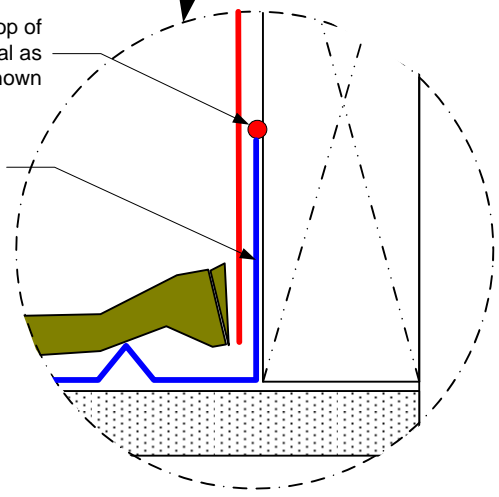

*Not To Scale.*

**GENERAL:**

Metro panel is cut to Side-Wall Underpan metal as shown. Standard Z-Bar metal is used to counter-flash over the Side-Wall Underpan metal.

**(1) PANELS:** Metro panels installed directly onto the rood deck as shown. Normal installs use four (4) fasteners in the back flange and four (4) in the front down-turn nose of each panel. For High Wind (HVHZ) areas, FIELD, PERIMETER & CORNER panels are fastened with six (6) in the back flange and six (6) in the front down-turn nose per panel.

**(2) FASTENERS:** All fasteners to be a minimum of 1,000hr Corrosion Resistant. Panels & Accessories fastened with #10 X 2-inch Hex Head Screw or 2-3/8-inch X .131-inch Dia. Ring Shank Black nails.

**(3) METRO Stone-Coated Z-BAR COUNTER FLASHING.** installed as shown. Z-Bar metal is positioned onto a backing block approximately 3-1/2 high to support Z-Bar metal. Exterior building paper & Siding material is flashed over Z-Bar metal as shown.

**(4) METRO Side-Wall Under-Pan** installed as shown up under counter-flashing or Z-Bar metal..

**(5) ROOFING SEALANT.** A bead of sealant is applied to the top of the Side-Wall Underpan for added weather protection in severe climates.

|          |          |   |           |
|----------|----------|---|-----------|
| FILENAME |          | 004EX-ROOF-TO-SIDEWALL-METRO-UNDERPAN-&-Z-BAR.VSD |           |
| DATE     | 12-28-07 | REVISED   | 9/26/2014 |

**Metro Roof Products**  
 3093 'A' Industry St., Oceanside  
 CA USA 92054  
[www.metroroofs.com](http://www.metroroofs.com)